



## **INTELLIGENT AUTOMATIC**

### *Flap turnstile*

CF series flap turnstile is an innovative pedestrian control technology that designed to achieve best balance of quality, performance and affordability.

CF series flap turnstile provide a combination of reliable mechanical as well as electronic restriction for unauthorized visitor while still maintain a welcoming atmosphere. Access control and time attendance reader can be integrated into flap barrier.

CF series flap turnstile is ideal indoor solution for railway platform, passenger terminal, ferry, airports, checkpoints, factories, stadium, lift lobby of commercial, industrial or government building. Flap barrier give a more premium and organized entrance to your building.

**Premium  
Automation**

## **MODEL**

### *S4T238FL-YE Series*



## TECHNICAL SPECIFICATION:

Description	Parameters
Lane Width	550-570mm
IP	IP54
Pass Speed	25-30 persons/min
Power supply	AC220V/110V,50/60Hz
Drive Mode	Motor drive
Max Power Consumption	200W
Opening time	0.06S
Humidity	≤90% coagulation free
Noise	≤50dB
Service Life	3,000,000 cycles
Outside packing	145x110x24 cm
Working Environment	-20° C~+60° C
Gross Weight	85KGS

## DIMENSION:

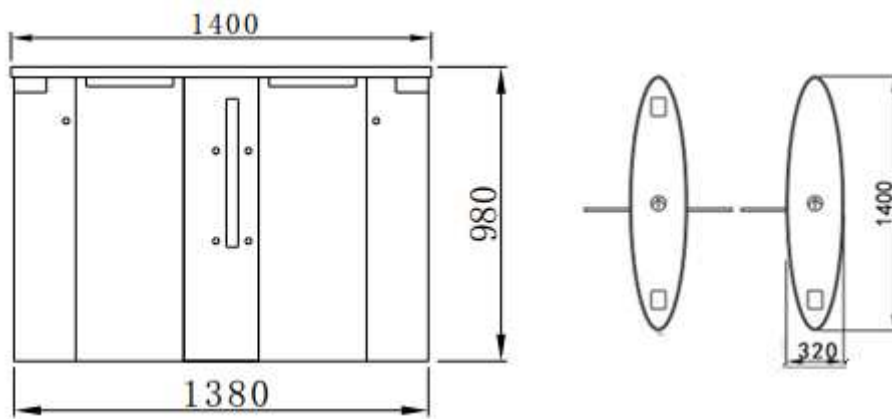

## Features:

### 1 RELIABILITY

Patented compact mechanism ensures the long life of the lubricating oil inside and high quality electrical components.

### 2 WIDER AND FASTER OPENING

Compared to tripod turnstile, flap barrier allow wider opening for user to bring along luggage or big parcel. Compared to swing barrier, flap barrier offer more faster opening by retracting its wing instead of swing open.

### 3 SAFE AND FRIENDLY

Flap wing can also be configured to auto-reverse when safety IR sensor detected user to avoid crushing onto user. During power failure, flap will automatically open by itself to allow free passage for emergency escape. Flap will automatically closed back when power resume. LED display at the front show if the lane is available or closed for maintenance.

### 4 ANTI TAIL-GATING

Smart lock mechanism effectively allow only one person to pass through at a time. Arm will automatically relock back if nobody pass through after a preset delay time.

### 5 STRICT SECURITY

SFlap wing will auto close if there is no pedestrian or pedestrian inside the lane is taking longer than allowed time limit to pass through. This avoid any unauthorized person to sneak into the building when flap was opened wrongly. The delay time can be preset.

### 6 ALARM DETECTION

Alarm light at top cover helped guard to easily identify alarm event for immediate response.

## Flap Turnstile

### Different type

Flap turnstile can be divided into one wing flap turnstile and double wings flap turnstile.

One wing flap turnstile, only with one wing on the housing, one channel combined by two pieces one wing flap turnstile.



Double wings flap turnstile, with two wings on the housing, two channel combined by one piece double wings flap turnstile with two pieces one wing flap turnstile.

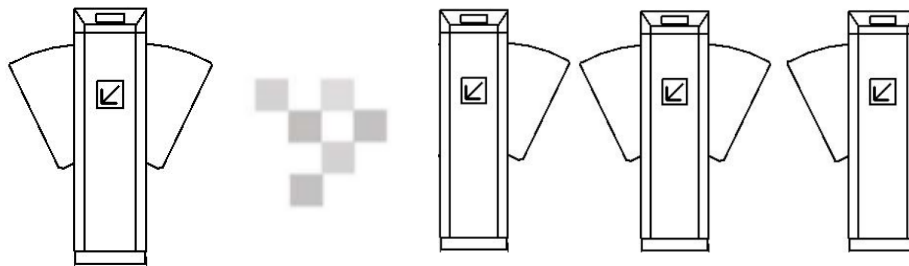

## Housing

### Diagram

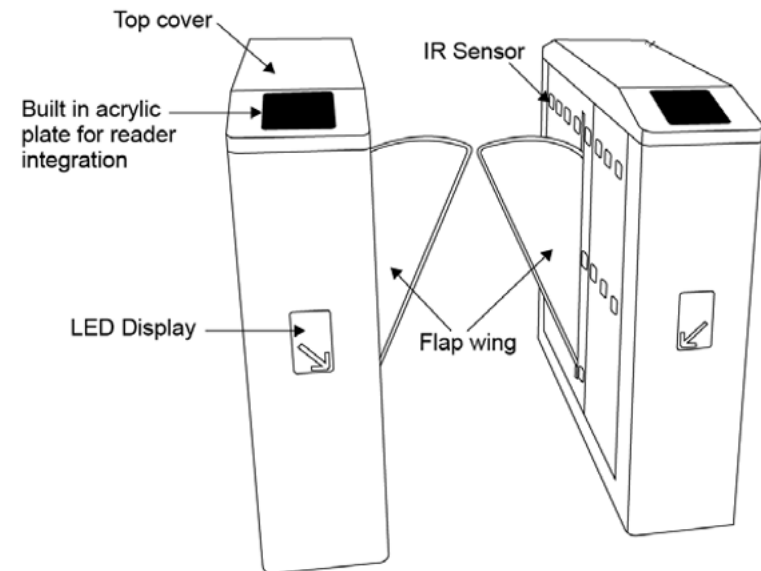

## **Status And Direction Light Indication**

Green Arrow indicates that the turnstile is unlock to permit a passage and shows the direction of authorized passage;

Red Cross indicates that passage is not allowed and shows that the turnstile remains in locked status.



## **Control Over Turnstile**

From the remote control panel or a wireless remote control(in the pulse control mode).

From access control system via a controller (in either pulse or potential control mode).

The turnstile is a normally closed unit(N/C),it remains unlocked until it receives a valid authorization or is unlocked with a mechanical release key.

If integrated into a fire alarm system,the turnstile can also be automatically unlocked by fire alarm signal.

## **Operating Modes**

Single passage in the set direction(the turnstile is open for one passage in the permitted direction and closed in the opposite direction).

Bi-directional single passage(the turnstile is open for one passage in each direction).

Free passage in the set direction(the turnstile is open for multiple passages in the permitted direction and closed in the opposite direction).

Free passage in the one direction,single passage in the opposite direction(the turnstile is open for multiple passages in the permitted direction and one passage in the opposite direction).

Always free(the turnstile is open for entry and exit).

Always locked(the turnstile is closed for entry and exit).

## **Housing Optional**



**S4T238FL-YB**



**S4T238FL-YT**



## Materials

Turnstile Housing: high quality powder coating steel or stainless steel  
Wing : acrylic or PMMA

## Timeout Facility

The turnstile has a preset timeout period(the passage waiting time) when the turnstile is unlocked to allow a passage in the permitted direction.

A timed auto re-lock if the passage has not begun (if not rotated) over this period is a standard feature.

The passage waiting time in the pulse control mode is 5 seconds regardless of the control signal duration. In the potential mode the passage waiting time is equal to the control signal duration.

## Interface

"Fire Alarm" control input to unlock the turnstile when an appropriate signal is received from fire alarm system or emergency button.

Relay outputs to connect remote light indicators, an intrusion detector, a siren and an emergency unlocking device.

Galvanic decoupling of the outputs to ensure noise-immunity of the turnstile electronic.

The logic is protected against short circuits, overloads and polarity inversion.

## Warranty

The warranty period is 12 months commencing from the date of sale.

## Housing *Optional*



**S4T238FL-YH**



**S4T238FL-YK**

