

WiFi Doorbell

User Manual



App Name is IPBell, Scan QR code to download APP



IPBell



iOS



Android

WiFi doorbell connects WiFi or network cable. After visitor calls, Smartphone or tablet interact with doorbell via real time video and audio, unlock, take photos, take videos, and alarm.

P2P cloud service push messages of visitor calls, PIR and tamper alarms.

WiFi doorbell has capabilities of tamper alarm, PIR detection, night view.

8 doorbells and 8 mobile devices can work at the same time.

1 App Introduction

Download the app from the iTunes App Store® or the Google Play Store®. Search "IPBell" and select our free app. You can scan bar code in the cover to download the APP.

APP contains the following language, language same as mobile device :

Simplified Chinese, Traditional Chinese, English, French, German, Japanese, Dutch, Italian, Spanish, Mexico, Korean, Brazil, Portuguese, Danish, Finnish, Norwegian, Swedish, Russian, Polish, Turkish, Ukrainian, Arabic, Croatian, Czech, Greek, Hebrew, Romanian, Slovak, Thai, Indonesian, Malay, Hungarian, Vietnamese, Hindi.

Display portrait and landscape screen

2 Features

Service	Service	P2P Service
Audio	Format	ADPCM
	Processor	2 -way audio
Video	Format	H 264
	Sensor	1/4 CMOS Ov9712, 1 Mega Pixels
	Frame Rate	25 fps
	Lens	3.6mm
Night vision	Night vision	Good
Network	Network	1 WiFi 2 Network cable
Alarm	Alarm	PIR and tamper alarms
	Action	PIR alarm push messages, Tamper alarm call to mobile device
Other	Waterproof	IP55
	Power	DC9~16V 1A or POE
	Temperature	-20~55 °C
	Humidity	10-95% RH
	Weight	G.W.: 600g
	Function	Real time video and audio, unlock, alarm

3 Packing List

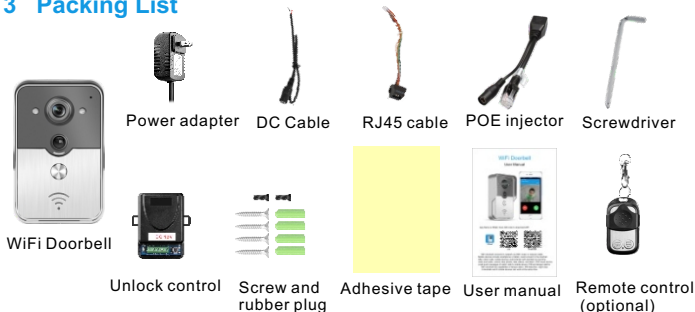

4 Interface

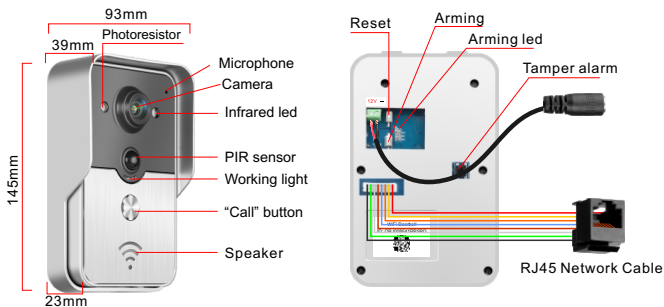

Doorbell in disarming state if arming led is on after power on, will enter arming state and arming led is off after press the arming button. will sound a alarming after press arming button under arming state.

5 Network connections and power supply

Select power supply and network for doorbell, near the doorbell

- 1 Has power and network cable, plug the network cable and power
- 2 Has power but no network cable, plug the power and connect to WiFi, try to ensure that the doorbell received signal strength is higher

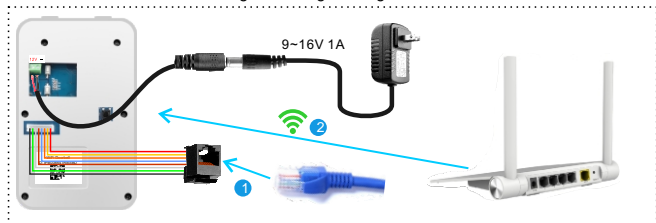

- 3 Has network cable but no power, refer to the following application diagram
- 4 No power and network cable, refer to the following application diagram

6 Application

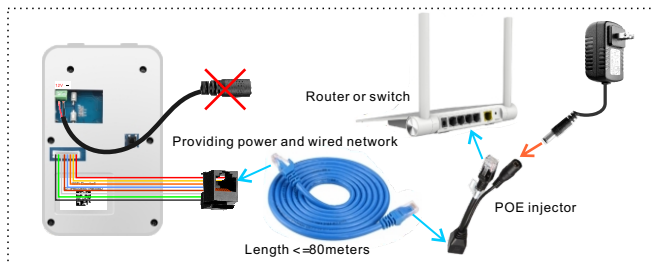

7 Installation

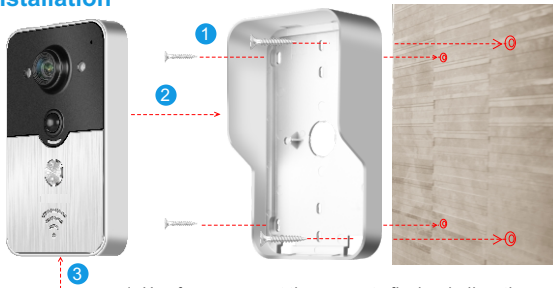

1 .Use four screws at the corner to fix doorbell on the wall

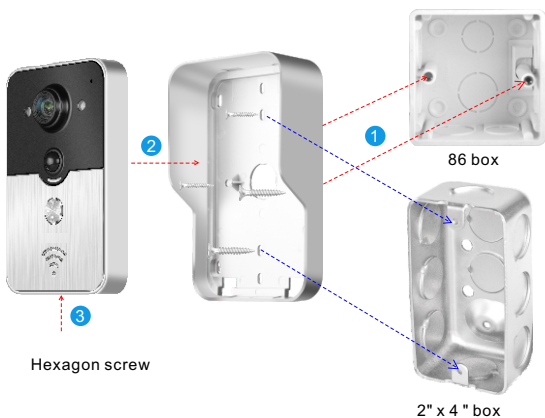

2 .Use two screws in the middle to fix doorbell to the 86 box or 2"x4" box

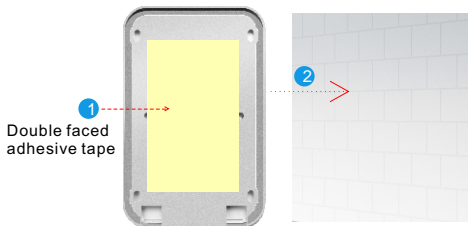

3 .Use adhesive tape to fix doorbell on the door or wall

8 1 Add doorbell into mobile device

8 1.1 Mobile device join to doorbell's hotspot

(Ignore this step if connect to a wired network or non-administrators)

The first one to add doorbell into network is administrator. The wireless router should be placed near the doorbell. Try to less metals, brick walls between doorbell and router to get a better WiFi signal.

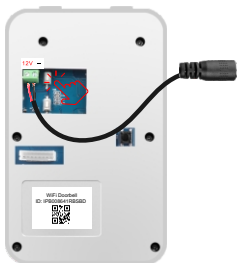

Press "Reset" button to reset doorbell after power on. And there is voice prompt.



1. Press "Call" button for more than 3 seconds then generated hotspot.

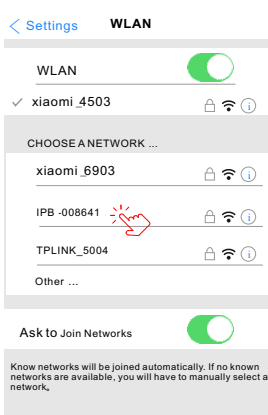

2. Choose the hotspot like "IPB-XXXXXX" (XXXXXX is 6 figures)

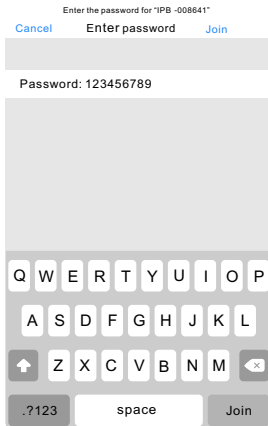

3. Input the default password as "123456789" then click "Join"

8 1.2 Input information

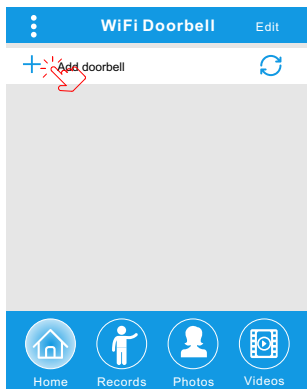

- 4 .Mobile device connect to 3G/4G cellular data or WiFi, run app to main interface, touch + to add a new doorbell

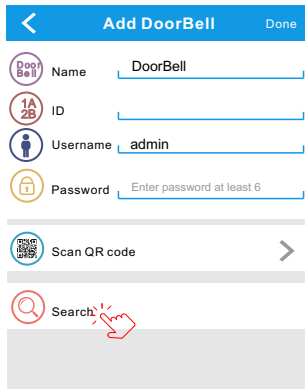

- 5 .Default name is DoorBell. administrator's username is "admin" at first, can't modify here, can modify after add the doorbell. Ensure mobile device and doorbell are in the same network if touch "Search" .

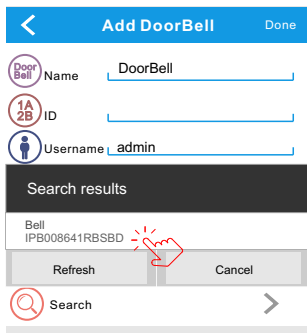

- 6 . Select the ID whose prefix is IPB, followed by 6 figures that are same as hotspot's 6 figures. non-administrators could manually input or scan QR code, also could search ID if within same LAN.

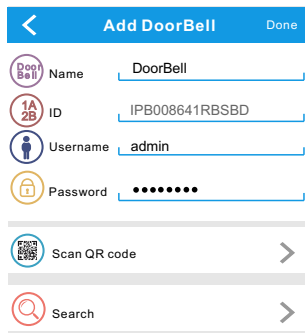



- 7 . Input username (minimum length is 5) and password (minimum length is 6), then click "Done"

8.1.3 Join router

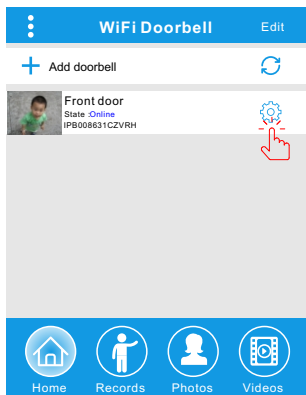
(Ignore this step if connect to a wired network or non-administrators)



8. Current doorbell status should be online.
If it's offline, touch , then touch .

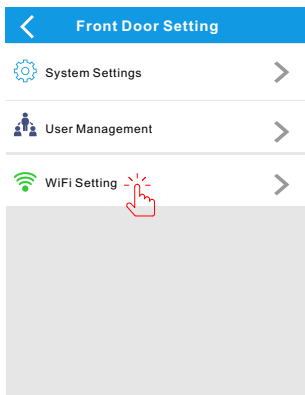

9. Touch "WiFi Setting"
support 802.11b/g/n/ac wireless router

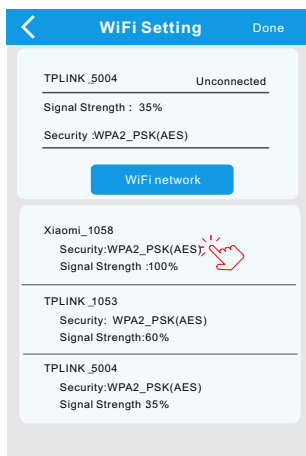

10. Touch "WiFi network".
The available router will be displayed.
Please choose target router.

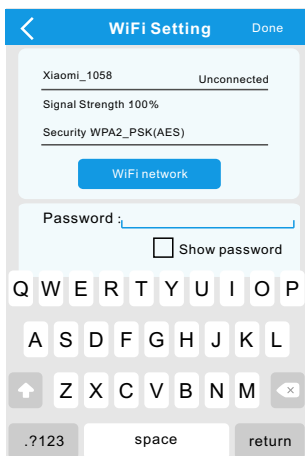

11. After input password, please touch "Done".
Then doorbell will restart. After 40 seconds,
doorbell will be in online state.

8 2 Doorbell status

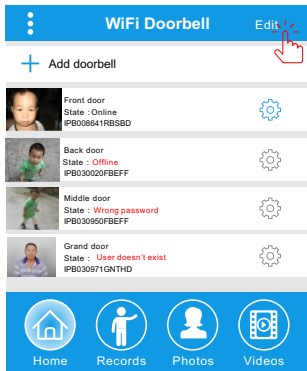

Status include online, **offline**, **wrong password**, **user doesn't exist**, **connecting**. "Connecting" means mobile device is not connected to network.

Same user connect one doorbell could not log in multiple mobile devices simultaneously.

8 3 Delete doorbell

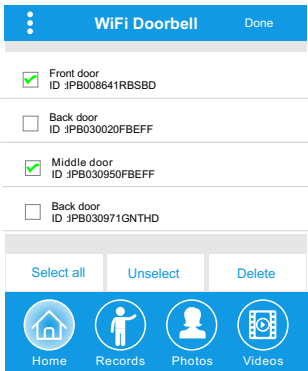

After touch "Edit", then touch "Done" you could delete or batch delete.

8 4 Edit doorbell

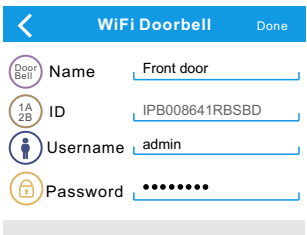

Edit doorbell name ,username, password, then touch "Done"

9 Monitor

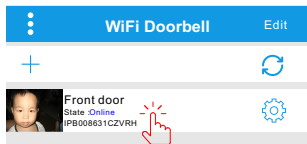

Touch to monitor when it's online. You can take photo, video, alarm, but can't unlock.

10 Settings

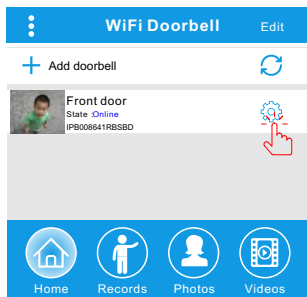

If doorbell is offline, click . If still offline, check network setting. When doorbell is online, touch to enter setting.

10.1 System Setting

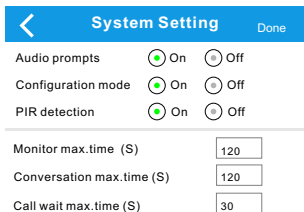

Audio prompts:

There is audio prompt when you press doorbell or add new doorbell.

Configuration mode:

Only administrator has permission to setting.
Suggest turn off after add doorbell.

PIR detection:

When it's on, there will push messages of visitor to mobile devices.

10.2 User management

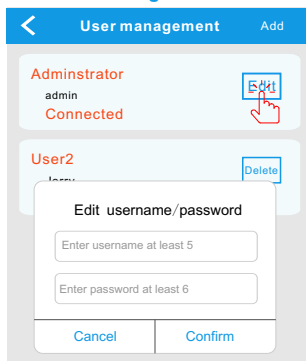

Administrator edit own username and password

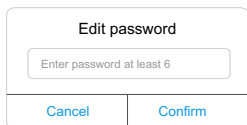

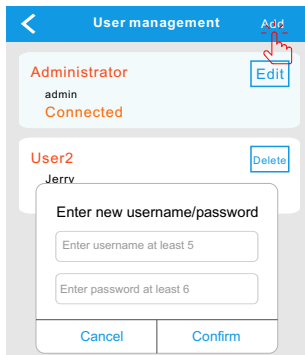

Non-administrators edit own password

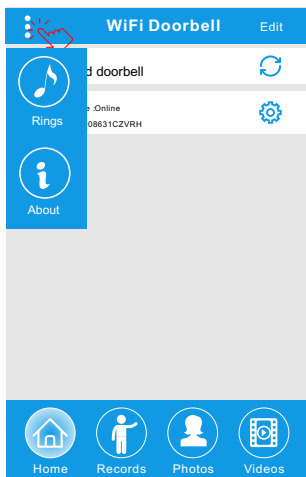

Administrator could add or delete users

11 Ring setting



Touch  to set ring ,view software version or exit.

12.2 Photos and Videos

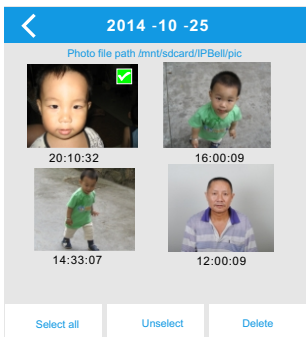

Photos are stored by time sequence .Touch to view in bigger size. Hold for a few seconds to delete one or multiple photos.

12.1 Records

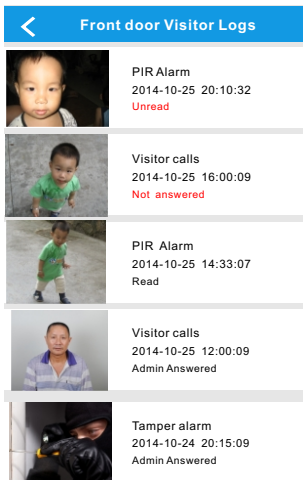

View the history records of visiting info. It includes visitor photos, date/time, and actions such as Admin answered, **Not answered**, Read, **Unread**.

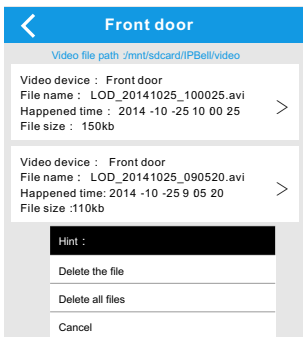

Press the file to play the selected file. Please install one if there is no video player, Hold for a few seconds to delete one or multiple videos.

13.1 Call

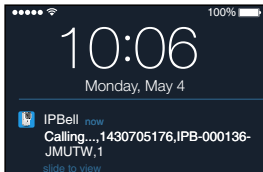
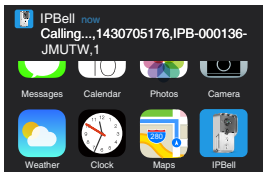

- 1 . After visitor calls ,iOS mobile device receive one push notification when working(left image) or standby(right image) ,touch (working mode) or side (standby mode) to view the notification

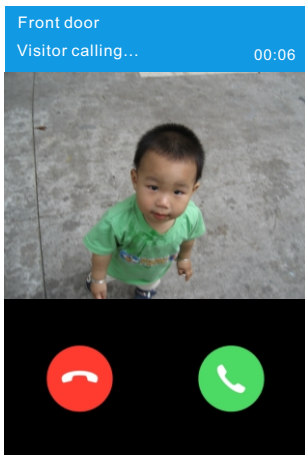

- 2 . iOS and Android mobile device will enter above interface ,others will auto hang up if any mobile device answers .

13.2 Take video



Touch "Video" icon to start taking video
Touch the icon again to end recording.

13.4 Alarm



In case you feel danger or threat from your door,
Doorbell sound a warning if touch "Alarm" icon.

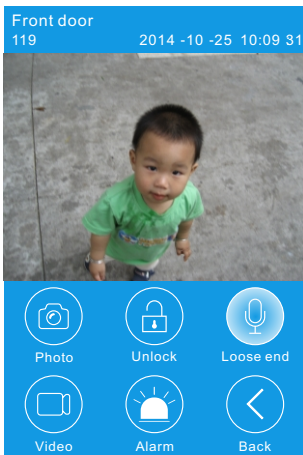

- 3 . Hold the "Hold to talk" button to talk ,
release the button to hear visitor's voice .

13.3 Take photo



Touch "Photo" icon to take photos.

13.5 Unlock



After you receive the call from visitor ,
touch "Unlock" icon to release the lock.

14 Unlock setting

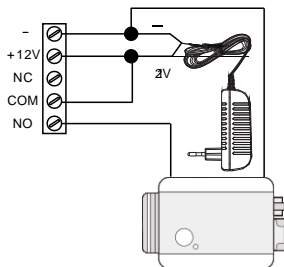

Power on unlock diagram

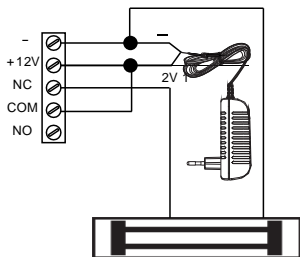

Power off unlock diagram

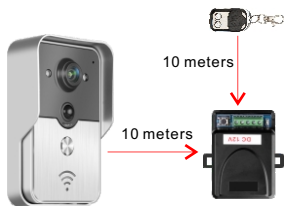
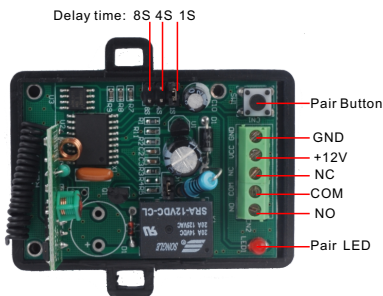

Pair unlock control with doorbell

Unlock control and doorbell connected to the power adapter both. Firstly press "Call" button of doorbell, mobile device run the app answer and enter intercom state, press "Pair" button of unlock control, then click "Unlock" button of APP, now pair light will continuously flash. Once again press the pair button of unlock control, pair light stops flashing. Finally click "Unlock" button of APP, the pair light will flash 3 seconds, it means that pairing is successful.

Pair remote control with unlock control

Unlock control is connected to power adapter. Firstly press the pair button of unlock control, pair light will flash once. Press the button of remote control, pair light will continuously flash. Once again press the pair button of unlock control, pair light will stop flashing. Finally press the button of remote control, the pair light will flash 3 seconds, it means that pairing is successful.